

*diplomat* SAFE

# INSTRUCTION



REDL



*diplomat*  
SAFE LTD

[www.dsafe.co.kr](http://www.dsafe.co.kr)

# HOW TO OPERATE *diplomat* NEW REDL 21?

## How to open?

- Grasp both sides of the upper round and press to move it out and open to the left, and load batteries (1.5V AA Alkaline 4 pcs). Then, LED flickers with the sound of Bi Bi Bi Bi.
  - The initial code from the factory is 1 2 3 4.
1. Push Start Button **C** (LED flickers with Bi sound).
  2. Push Initial Code **1 2 3 4** in sequence (LED flickers with Bi sound).
  3. Push Finish Button **#** (Melody rings).
  4. Turn Knob (or Handle) clockwise and open door while melody rings.

In case that wrong code entered, the lock sounds Bi Bi Bi Bi.

If wrong code tried over 5 times, the lock gets paralysed and doesn't work.

How to release the lock from paralysis?

Enter original code twice consecutively as in opening procedure.

(No sound but LED flickers when button pushed. If procedures are followed exactly, melody rings and the lock recovers).

EX) **C 1 2 3 4 # C 1 2 3 4 #** (Melody rings)

## How to enter your personal code?

- Two different codes are available.

### 1st Code

1. Push Memory Button **M** in the back of door (LED flickers with Bi sound).
2. Push Button **1** (LED flickers with Bi sound).
3. Push Finish Button **#** (LED flickers on with Bi— sound).
4. Enter the 1st Code. (4 digits min to 16 digits max.)
5. Push Finish Button **#** (Melody rings).

EX) In case of Personal Code 2 0 0 2, push buttons **M 1 # 2 0 0 2 #**

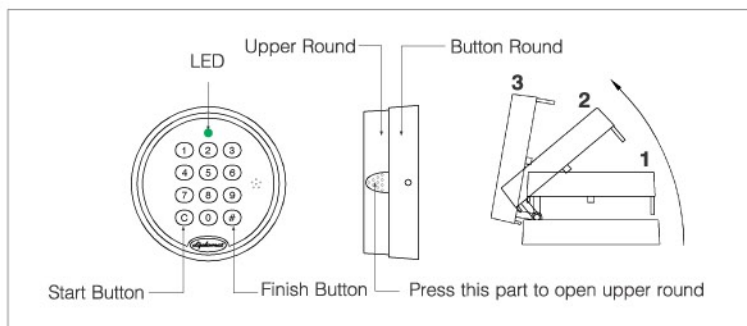

## 2nd Code

1. Push Memory Button **M** (LED flickers with Bi sound).
2. Push Button **2** (LED flickers with Bi sound).
3. Push Finish Button **#** (LED flickers on with Bi — sound).
4. Enter the 2nd Code (4 digits min to 16 digits max).
5. Push Finish Button **#** (Melody rings).

EX) In case of personal Code 4 4 0 0, push buttons **M 2 # 4 4 0 0 #**

## How to change your personal code without opening door?

1. Push Finish Button **#** (LED flickers with Bi sound).
  2. Push your present personal code  
(LED flickers with Bi sound).
  3. Push Finish Button **#** (LED flickers with melody).
  4. Push New Personal Code (4 digits min to 16 digits max).
  5. Push Finish Button **#** (Melody rings).
- EX) If you want to change present code 1 2 3 4 into new code 5 6 7 8,  
push buttons **# 1 2 3 4 # 5 6 7 8 #**

**⚠ Caution :** To confirm if the code is exactly entered, push the code in opening procedures prior to closing door, For example, in case of your code 1 2 3 4, push buttons **C 1 2 3 4 #**. If the procedure is properly done, melody rings for four seconds.

## When to replace batteries?

If door is not opened in spite of exact code (LED flickes with melody), it indicates that battery is not strong enough to actuate solenoid. Then, batteries should be replaced with new ones. (1.5V Alkline AA 4 pcs)

- The personal code is not erased even if battery is completely exhausted.
- Battery life span : 3 years. (In case of door opening 3 times a day)

S A F E   A N D   S O U N D

GLOBALLY REPUTED

*diplomat* **SAFE**



*diplomat*  
SAFE LTD 

1583-4 SONGJUNG - DONG GANGSEO - GU BUSAN, KOREA TEL (82 51) 831 - 4400 FAX (82 51) 831 - 4409

E-mail : [info@dsafe.co.kr](mailto:info@dsafe.co.kr) [www.dsafe.co.kr](http://www.dsafe.co.kr)